

## 防草法面パネル

110

参考重量154kg

140

参考重量198kg

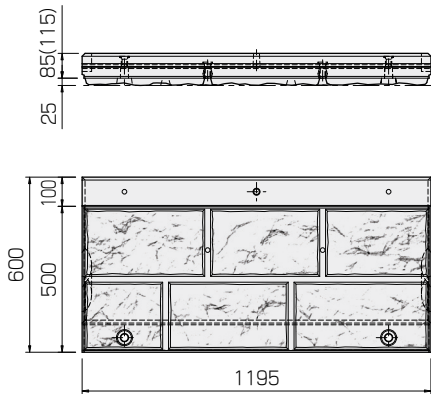

※( )内は140

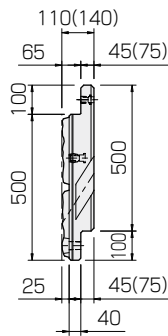

使用例

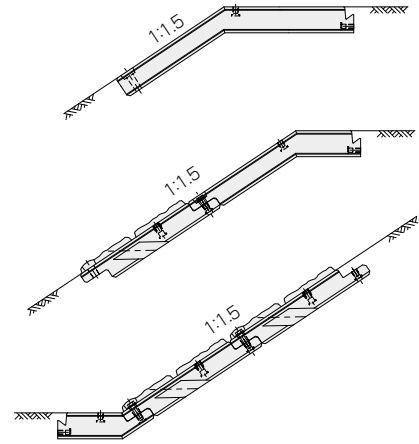

## 防草法肩ブロック

500

参考重量259kg

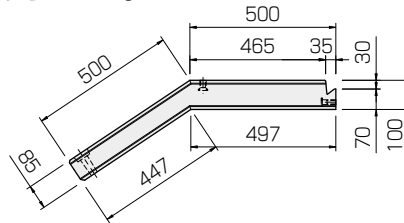
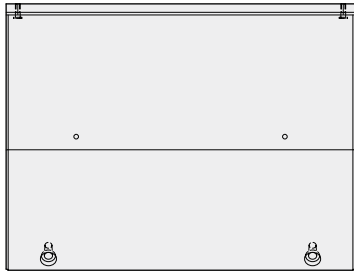

250

参考重量186kg

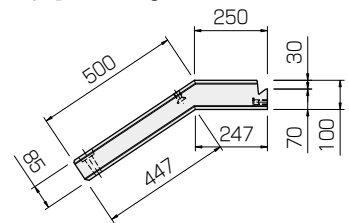

500PJ

参考重量246kg

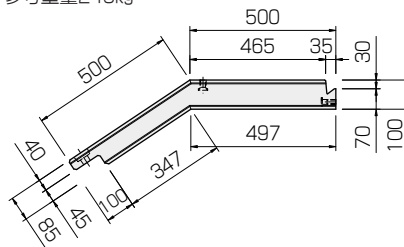
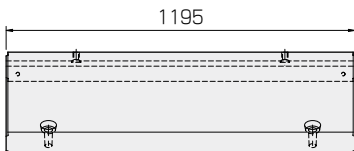

250PJ

参考重量173kg

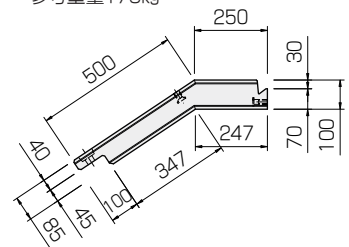

## 防草法尻ブロック

500

参考重量260kg

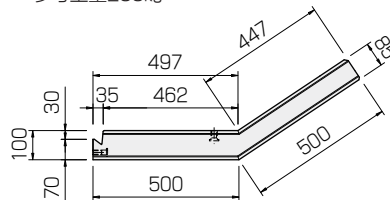
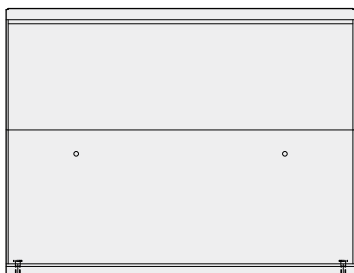

250

参考重量187kg

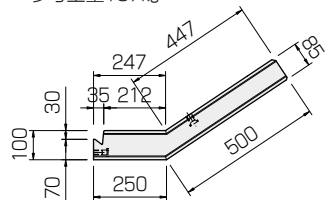

500PJ

参考重量161kg

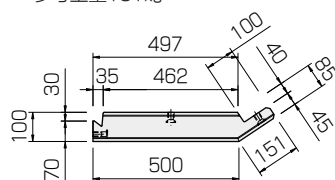
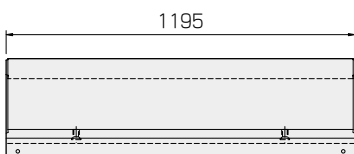

250PJ

参考重量88kg

